



# OVERVIEW

---

## Table of Contents

	<a href="#">Introduction</a>
	<a href="#">Offices, Branches, Subsidiaries</a>
	<a href="#">International Collaboration</a>
	<a href="#">Work Experience</a>
	<a href="#">List of Projects Summarized by Category</a>
	<a href="#">Certificates</a>
	<a href="#">Memberships</a>
	<a href="#">Awards and Recognitions</a>



# Introduction







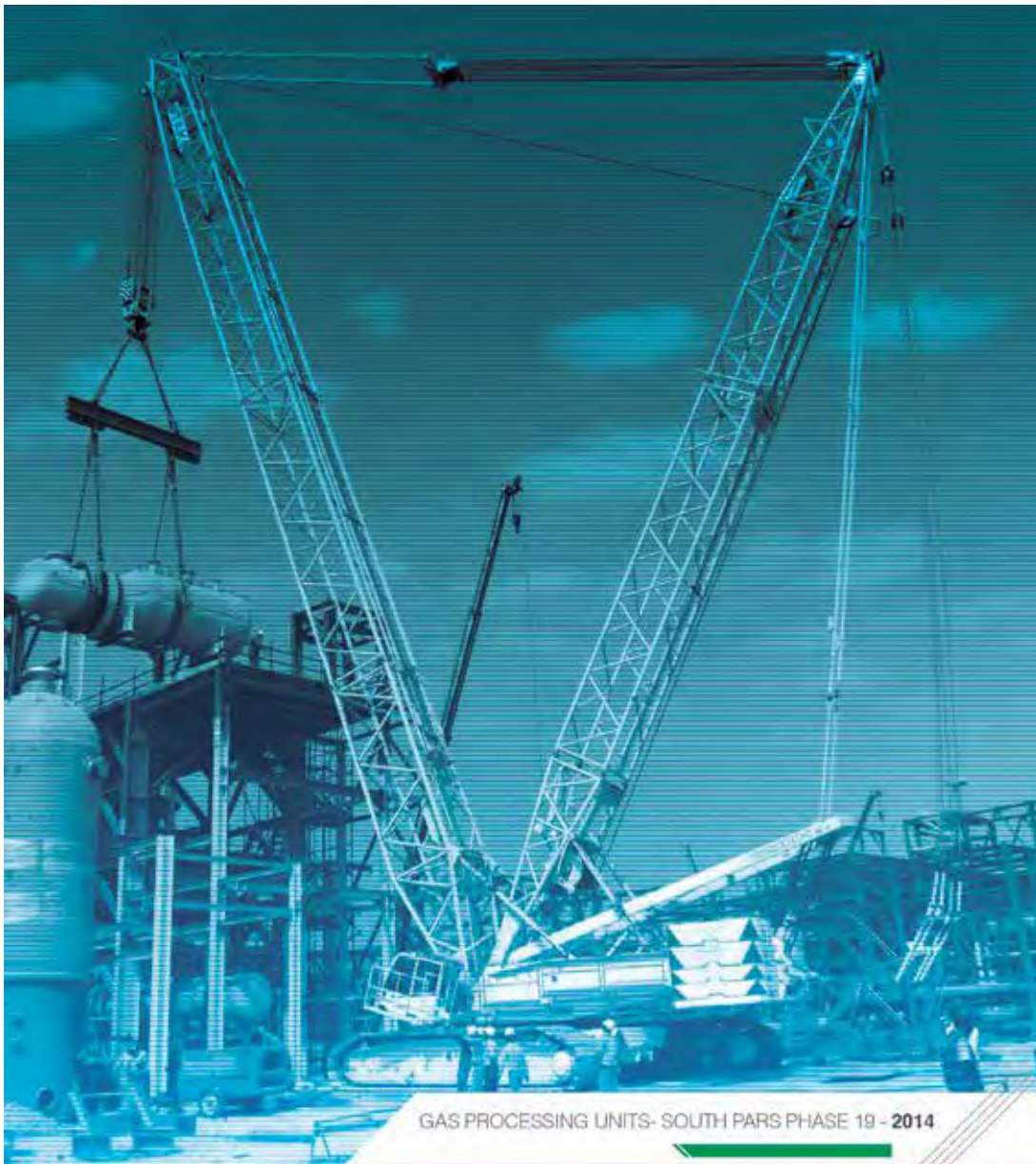

GAMMA is a leading private construction and erection company established in Iran in 1955. GAMMA has ever since been actively involved in execution of over 110 projects of various natures. We provide engineering, procurement, and construction services with capabilities across the life cycle for midstream, downstream facilities and infrastructures.



CIVIL & BUILDING WORKS - SOUTH PARS PHASES 4&5 - 2005

# Offices, Branches, Subsidiaries

---





## Offices, Branches, Subsidiaries

**NAME:** GAMMA COMPANY (Civil & Mechanical Contractors)

**ESTABLISHMENT:** Registration No. 5136, Tehran, Iran

Registration Date 1955

### Head Office

Address: No.1 & 1/1, J.Kargar St., Shariati Ave., Tehran, Iran

Post Code: 1563795311

Tel: +9821-7753-2986~8

Fax: +9821-775-33185

### Building No.1

Address: No.1, 6th St., 16th . Ave., Lashgari ( Makhsoos ) Freeway, Tehran, Iran

Post Code: 1389797461

Tel: +98-21-4450-4991 , +98-21-47290-000

Fax: +98-21-4450-6466

Address: GAMMA Co., Bidkhoon, South Pars Gas Filed, Assaluyeh, Iran

Post Code: 138/75391

Tel: +9877273 3446~50

Fax: +9877273 22071

### Subsidiary Gamma-Akvan Company

-Construction Equipment Services

-Heavy Civil Works

**Web site:** [www.gamma-ir.com](http://www.gamma-ir.com)

**E-mail :** [info@gamma-ir.com](mailto:info@gamma-ir.com)

### Subsidiary Ginsco Company

-Trading

-Industrial Procurement Services.

Address : No.1, 6th St., 16th . Ave., Lashgari ( Makhsoos ) Freeway, Tehran, Iran

Tel : +98 (21) 47290-000

Fax : +98 (21) 44540675

**Web Site :** [www.ginsco.co](http://www.ginsco.co)

**Email :** [info@ginsco.co](mailto:info@ginsco.co)

# International Collaboration

---



## Following is part of the list of International Companies that Gamma has collaborated with while executing and delivering projects in Iran:

- Technimont, Italy
- GS, South Korea
- ENI / Agip, Italy
- Total/Hyundai, France/South Korea
- China Tianchin Engineering Corporation (TCC)
- Danieli, Italy
- Danieli, Italy
- Saipem/T.P.L., Italy
- Filippo Fochi, Italy
- Davy Power Gas
- Kajima Corporation, Japan
- Hazama Gumi, Japan
- Hazama Gumi, Japan
- Kajima Corporation, Japan
- Nippon Concrete Industries, Japan
- Mitsubishi Heavy Industries, Japan
- Ingra, Yugoslavia
- Simon Carvs, England
- Snam Progetti, Italy
- C.J.B., England
- Stokvis, Holland
- Westinghouse, U.S.A.
- Philips, Holland
- Lummus, England
- Flour International, U.S.A.
- Leader, Consortium, South Pars Phase 12, Tombak
- Erection works South Pars phases 9 & 10 Assaluyeh
- Building & Civil works South Pars Phases 4 & 5 Assaluyeh
- Civil and Foundation Work, South Pars phases 2 & 3 Assaluyeh
- Mekpco Methanol Plant
- Steel Making Facilities, Khorasan Steel Complex
- Rolling Mill, Khorasan Steel Complex
- W.W.T. Plant, Arak Refinery, Arak
- Pipe ways & Bridges, Arak Petrochemical Complex, Arak
- Shiraz Petrochemical Complex
- Olefins Plant, Bandar Imam Petrochemical, Complex, Bandar Imam
- Chlorine-Alkali Plant, Bandar Imam Petrochemical Complex, Bandar Imam
- Electrolysis Plant, Bandar Imam Petrochemical Complex, Bandar Imam
- C.M. Plant, Bandar Imam Petrochemical Complex, Bandar Imam
- Concrete Pile Factory, Bandar Imam
- Plasticizer Plant, Bandar Imam
- Lavan Island Refinery, Lavan Island
- Carbon Black Plant, Ahwaz
- Offsite works of Fars Refinery, Shiraz
- Sugar Factory Ghochestan and Asad-Abad
- Ore Loading Plant, Bandar Abbas
- Power Plant, Tehran
- Micro Wave Stations, all over Iran
- Petrochemical Plant Sewage Disposal, Abadan
- Oil Pipe line from Tehran Refinery to Ray Reservoir

# Work Experience



## MIDDLE EAST KIMIYA PARS METHANOL PLANT

<b>LOCATION</b>	:	Assaluyeh , Iran
<b>OWNER</b>	:	China Tianchin Engineering Corporation (TCC)
<b>SERVICES PROVIDED</b>	:	Construction and Pre-Commissioning
<b>TYPE OF CONTRACT</b>	:	Lump Sum
<b>TYPE OF ASSOCIATION</b>	:	Construction Contractor
<b>STATUS</b>	:	In Progress

### DESCRIPTION AND MAJOR QUANTITIES OF WORKS:

Concrete	:	50,000	m3
Building	:	3,300	m2
Piping Fabrication & Erection	:	330,000	inch-Dia
Equipment Erection	:	14,750	tons
Electrical Work	:	250	km (Cabling)
Instruments	:	227	km (Cabling)
Painting	:	33,000	m2
Steel Structure Erection	:	10,500	tons
Insulation	:	50,000	m2

Execution of Civil, Building, Piping, Equipment erection, Steel structure, Electrical, Instrumentation, Paving, Insulation, and Precommissioning works.





## SOUTH PARS PHASES 9 & 10 ONSHORE FACILITIES

24" OFF TAKE FACILITIES FROM EXPORT GAS PIPELINE  
OF SP9&10 TO ASSALUYEH-SIRRI PIPELINE

<b>LOCATION</b>	: Assaluyeh , Iran
<b>OWNER</b>	: Pars Oil and Gas Company
<b>SERVICES PROVIDED</b>	: Procurement, Construction, Pre-commissioning, Commissioning, Start up and Performance Test
<b>TYPE OF CONTRACT</b>	: Lump Sum
<b>TYPE OF ASSOCIATION</b>	: Main Contractor
<b>STATUS</b>	: Completed, July 2018

### DESCRIPTION OF WORK:

Execution of Civil, Piping, Electrical, Instrumentation, Steel Structure and Painting works in an operating refinery in a fast track mode. In this project Procurement, Construction, Precommissioning, Commissioning, startup and performance test of the project, were carried out within 2.5 months simultaneously.



## SOUTH PARS PHASE 19 ONSHORE FACILITIES *LPG Export Pipeline*

<b>LOCATION</b>	:	Tombak , Iran
<b>OWNER</b>	:	Petro Pars IRAN
<b>SERVICES PROVIDED</b>	:	Construction and Pre-Commissioning for all civil and pipeline works of LPG export pipeline
<b>TYPE OF CONTRACT</b>	:	Construction Re-measurable
<b>TYPE OF ASSOCIATION</b>	:	Sub Contractor
<b>STATUS</b>	:	completed Feb,2018

### DESCRIPTION AND MAJOR QUANTITIES OF WORK

Concrete	:	15,000	m3
Piping Fabrication & Erection	:	50,000	inch-Dia(4 line , 8Km)

And Also Construction of Electrical & Instrumentation Works, Insulation & Painting Works and Pre-Commissioning Work.



## SOUTH PARS PHASE 14 ONSHORE FACILITIES

Units 102, 140, 141, 142, 143, 145, 147, 148 & 160

LOCATION	:	Tombak, Iran
OWNER	:	Industrial Projects Management of Iran (IPMI)
SERVICES PROVIDED	:	Construction
TYPE OF CONTRACT	:	Re- Measurable
TYPE OF ASSOCIATION	:	Contractor
STATUS	:	Completed , Dec 2016

### DESCRIPTION AND MAJOR QUANTITIES OF WORKS:

Remaining Civil works, Steel Structure and Underground Piping Network.

Concrete Works	:	25,000	m <sup>3</sup>
Earth Works	:	300,000	m <sup>3</sup>
Underground Piping	:	31,000	inch-Dia
Structural Steel	:	1,900	tons

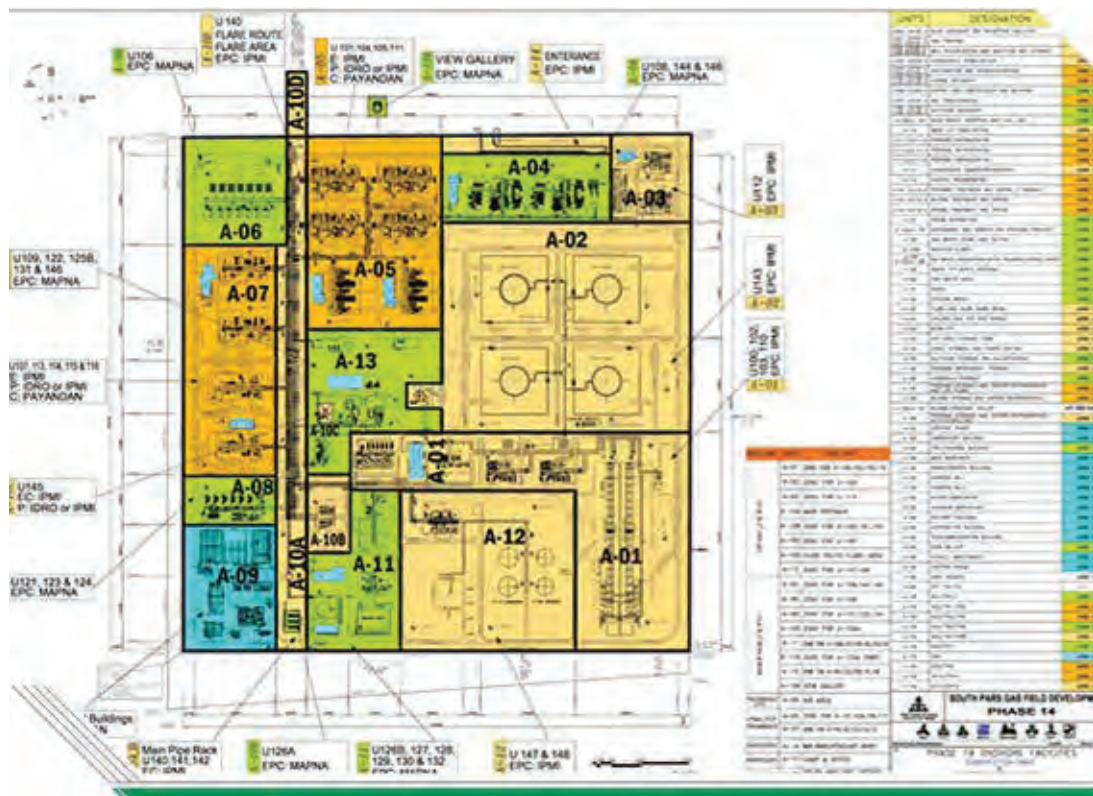



## SOUTH PARS PHASE 19 ONSHORE FACILITIES *SC4 (Utilities Area) & SC2-2 (Gas Processing Units)*

<b>LOCATION</b>	:	Tombak, Iran
<b>OWNER</b>	:	Petro Pars Iran
<b>SERVICES PROVIDED</b>	:	Construction, Erection & Partial procurement
<b>TYPE OF CONTRACT</b>	:	Lump Sum
<b>TYPE OF ASSOCIATION</b>	:	Sub Contractor
<b>STATUS</b>	:	Completed, June 2016

### DESCRIPTION AND MAJOR QUANTITIES OF WORKS:

Execution of Civil, Mechanical, Electrical and I&C Works of Utilities-(SC4) and Execution of Civil, and Mechanical Works of Gas Sweetening units and Burn Pit Zone (SC2-2)

Concrete	:	76,000	m3
Underground Piping C/S	:	53,000	inch-Dia
Underground Piping GRP	:	72,000	inch-Dia
Above Ground Piping	:	603,000	inch-Dia
Earth works	:	500,000	m3
Equipment Erection	:	9,700	tons
Electrical work	:	1,560	km of Cabling
Instruments	:	300	Km of Cabling
Insulation	:	41,000	m2
Painting	:	128,000	m2



## **SOUTH PARS PHASE 12 ONSHORE FACILITIES**

### *EPC3 (Gas Processing - Gas Treatment, Sulfur Recovery and related Facilities)*

<b>LOCATION</b>	:	Tombak, Iran
<b>OWNER</b>	:	PETRO PARS (Ltd.)
<b>SERVICES PROVIDED</b>	:	Construction, Erection, Partial Engineering, and Procurement
<b>TYPE OF CONTRACT</b>	:	Lump Sum
<b>TYPE OF ASSOCIATION</b>	:	Contractor (EPC Consortium Member)
<b>STATUS</b>	:	Completed, Feb. 2015

#### **DESCRIPTION AND MAJOR QUANTITIES OF WORKS:**

Onshore facilities for processing of the reservoir fluid with 3,000 MMSCFD capacity.

<b>Concrete</b>	:	84,900	M3
<b>Piping (UG &amp; AG)</b>	:	810,400	Inch-Dia
<b>Structural Steel</b>	:	14,100	Tons
<b>Equipment Erection</b>	:	15,300	Tons
<b>Electrical work</b>	:	730	Km of Cabling
<b>Instruments</b>	:	920	Km of Cabling
<b>Insulation</b>	:	71,600	M2
<b>Fire Protection</b>	:	20,200	M2
<b>Painting</b>	:	134,700	M2

**Permanent residential accommodation for 4,000 persons**



## SOUTH PARS PHASE 13 ONSHORE FACILITIES

### *Engineering of Camp Accommodation*

<b>LOCATION</b>	:	Tombak, Iran
<b>OWNER</b>	:	Petro Paydar Iranian
<b>SERVICES PROVIDED</b>	:	Engineering
<b>TYPE OF CONTRACT</b>	:	Lump Sum
<b>TYPE OF ASSOCIATION</b>	:	Contractor
<b>STATUS</b>	:	Completed, June 2011

### DESCRIPTION OF WORK

South Pars Gas Field Development

Basic design and detail engineering of residential accommodation for 12,000 people including, sport complex, restaurants and all required infrastructures such as roads, utilities, parking, street lighting, waste water treatment , power generation plant, etc.

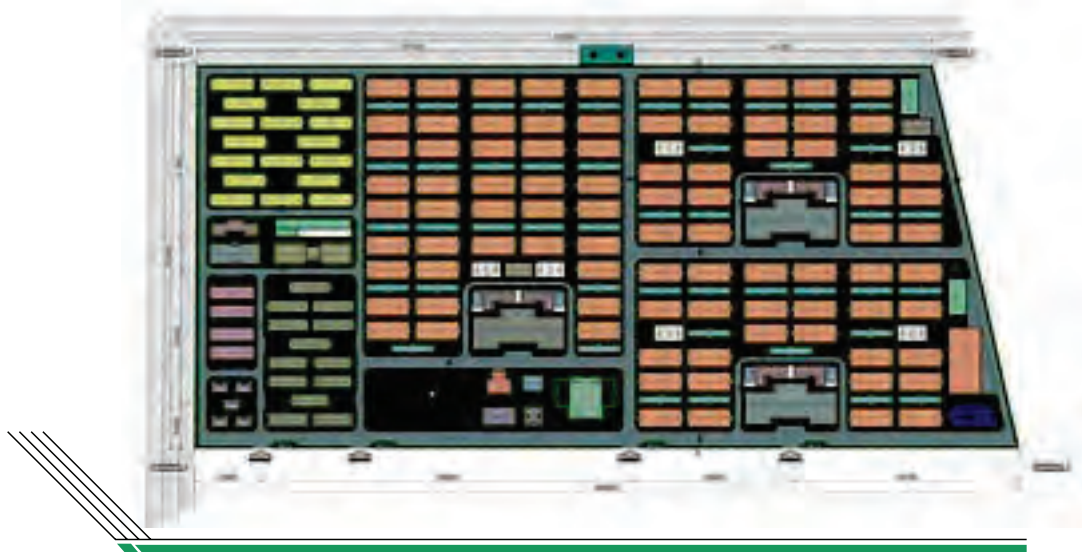

## SOUTH PARS PHASES 9&10 ONSHORE FACILITIES TGTU (Tail Gas Treatment Unit)

<b>LOCATION</b>	:	Assaluyeh, Iran
<b>OWNER</b>	:	OIEC
<b>SERVICES PROVIDED</b>	:	Construction, Erection, and partial Procurement
<b>TYPE OF CONTRACT</b>	:	Lump Sum
<b>TYPE OF ASSOCIATION</b>	:	Contractor
<b>STATUS</b>	:	Completed, May 2011

### DESCRIPTION AND MAJOR QUANTITIES OF WORKS:

On shore Tail Gas Treatment Unit.

Piping	:	90,000	Inch-Dia
Structural Steel	:	500	Tons
Equipment Erection	:	1,700	Tons
Electrical & Instrumentation	:	45	km of Cabling
Insulation, Fire Protection, and Painting			





## SOUTH PARS PHASES 9 & 10 ONSHORE FACILITIES

<b>LOCATION</b>	:	Assaluyeh, Iran
<b>OWNER</b>	:	OIEC
<b>SERVICES PROVIDED</b>	:	Construction , Erection, and partial Procurement
<b>TYPE OF CONTRACT</b>	:	Re-Measurable
<b>TYPE OF ASSOCIATION</b>	:	Contractor
<b>STATUS</b>	:	Completed, Oct 2006

### DESCRIPTION AND MAJOR QUANTITIES OF WORKS:

Plant reception facilities, and underground network for entire project.

Underground RC Pipe	:	3,700	M ( 100-32 Inch)
Earth Work	:	802,000	M3
Piping, AG	:	225,000	Inch-Dia
Structural Steel	:	6,000	Tons
Equipment Erection	:	3,700	Tons
Electrical	:	230	km of Cabling
Underground Steel Piping	:	110,000	Inch-Dia
Underground GRP Piping	:	210,000	Inch-Dia







## WASTE WATER TREATMENT FACILITIES

---

<b>LOCATION</b>	:	Tehran, Iran
<b>OWNER</b>	:	PARS OIL COMPANY
<b>SERVICES PROVIDED</b>	:	Construction & Procurement
<b>TYPE OF CONTRACT</b>	:	Re-Measurable
<b>TYPE OF ASSOCIATION</b>	:	Main Contractor
<b>STATUS</b>	:	Completed, 2009
<b>DESCRIPTION OF WORKS</b>	:	Underground and treatment facilities.

## SOUTH PARS PHASES 4 & 5 ONSHORE FACILITIES CIVIL & BUILDING WORKS

<b>LOCATION</b>	:	Assaluyeh, Iran
<b>OWNER</b>	:	ENI
<b>SERVICES PROVIDED</b>	:	Construction
<b>TYPE OF CONTRACT</b>	:	Re-Measurable
<b>TYPE OF ASSOCIATION</b>	:	Contractor (EPC Consortium Member with Hyundai Co)
<b>STATUS</b>	:	Completed, March 2005

### DESCRIPTION AND MAJOR QUANTITIES OF WORKS:

Plant Civil Works, Industrial, non Industrial Buildings, and double wall cryogenic LPG tank

Concrete Works	:	115,000	M3
Buildings	:	32,000	M2
Earth Works	:	2,270,000	M3





## ZAGROSS PETROCHEMICAL COMPLEX

### SITE PREPARATION

<b>LOCATION</b>	:	Assaluyeh, Iran
<b>OWNER</b>	:	Zagross petrochemical Company (National Petrochemical Company)
<b>SERVICES PROVIDED</b>	:	Construction
<b>TYPE OF CONTRACT</b>	:	Re-Measurable
<b>TYPE OF ASSOCIATION</b>	:	Contractor
<b>STATUS</b>	:	Completed, July 2002

#### DESCRIPTION AND MAJOR QUANTITIES OF WORKS:

Methanol Plant (Site Preparation)

Excavation	:	1,200,000 M3
Back Fill	:	470,000 M3

## JAM PETROCHEMICAL COMPLEX

### Site Preparation

<b>LOCATION</b>	:	Assaluyeh, Iran
<b>OWNER</b>	:	Jam petrochemical Company (National Petrochemical Company)
<b>SERVICES PROVIDED</b>	:	Construction
<b>TYPE OF CONTRACT</b>	:	Re-Measurable
<b>TYPE OF ASSOCIATION</b>	:	Contractor
<b>STATUS</b>	:	Completed, July 2002

#### DESCRIPTION AND MAJOR QUANTITIES OF WORKS:

Olefins Plant, Site Preparation

Excavation	:	1,400,000 M3
Back Fill	:	500,000 M3

## SOUTH PARS PHASES 2&3 ONSHORE FACILITIES CIVIL WORKS

LOCATION	:	Assaluyeh, Iran
OWNER	:	Total / Hyundai
SERVICES PROVIDED	:	Construction
TYPE OF CONTRACT	:	Re-Measurable
TYPE OF ASSOCIATION	:	Sub Contractor
STATUS	:	Completed, July 2002

### DESCRIPTION AND MAJOR QUANTITIES OF WORKS:

Construction of Pipe Racks, Pipe Sleepers, Tank Foundations, Reception Facilities, Process Trains, Flare Area, etc.,

Earth Works	:	620,000	M3
Concrete	:	43,000	M3





## **KHORASAN STEEL COMPLEX**

### **STEEL MAKING FACILITIES**

<b>LOCATION</b>	:	Neyshabur, Iran
<b>OWNER</b>	:	Khorasan Steel Company
<b>SERVICES PROVIDED</b>	:	Mechanical Erection
<b>TYPE OF CONTRACT</b>	:	Re-Measurable
<b>TYPE OF ASSOCIATION</b>	:	Contractor
<b>STATUS</b>	:	Completed, March 2002

#### **DESCRIPTION AND MAJOR QUANTITIES OF WORKS:**

Complete erection works of steel making and related facilities, designed and supplied by Danielli.

Installation of equipment	:	5,050	Tons
Piping (small & medium size)	:	350	Tons
Electrical & Automation facilities	:	500	Tons
Refractory	:	700	Tons



## **KHORASAN STEEL COMPLEX** **ROLLING MILL**

<b>LOCATION</b>	:	Neyshabur, Iran
<b>OWNER</b>	:	Khorasan Steel Company
<b>SERVICES PROVIDED</b>	:	Mechanical Erection
<b>TYPE OF CONTRACT</b>	:	Re-Measurable
<b>TYPE OF ASSOCIATION</b>	:	Contractor
<b>STATUS</b>	:	Completed, March 2002

### **DESCRIPTION AND MAJOR QUANTITIES OF WORKS:**

Complete erection works of the rolling mill and related facilities, designed and supplied by Danielli.

Installation of equipment	:	3,500	Tons
Piping (Small & medium size)	:	500	Tons
Electrical & Automation facilities	:	800	Tons
Refractory	:	1000	Tons



## FUEL SUPPLY JETTY

<b>LOCATION</b>	:	Bushehr, Iran
<b>OWNER</b>	:	National Iranian Oil Production and Distribution Co.
<b>SERVICES PROVIDED</b>	:	Construction, Erection, and Procurement
<b>TYPE OF CONTRACT</b>	:	Re-Measurable
<b>TYPE OF ASSOCIATION</b>	:	Contractor
<b>STATUS</b>	:	Completed, September 1998

### DESCRIPTION AND MAJOR QUANTITIES OF WORKS:

Complete construction of a fuel supply jetty having 170m of berthing space.

Dredging	:	3500	M3
Earth work	:	4000	M3
22 & 24 Dia steel Piles	:	104	No.
Fender Piles	:	85	No.
Sheet piles	:	112	M
Piping & Pipe Supports	:	44	Tons
Concrete work	:	900	M3
Steel Structure	:	240	Tons
Wooden Fenders	:	90	M3
Rubber Cell Fenders	:	53	No
Cathode Protection-Anodes	:	89	No
Electrical work	:	2.5	Tons
Bollards	:	19	No





## WASTE WATER TREATMENT PLANT ARAK 7<sup>th</sup> REFINERY

LOCATION	:	Arak, Iran
OWNER	:	National Iranian Oil Company / Saipem
SERVICES PROVIDED	:	Construction and Erection
TYPE OF CONTRACT	:	Re-Measurable
TYPE OF ASSOCIATION	:	Contractor to Saipem
STATUS	:	Completed, September 1994

### DESCRIPTION AND MAJOR QUANTITIES OF WORKS:

Complete construction and erection of waste water treatment plant of Arak Refinery.

Earthworks	:	75,000	M3
Concrete	:	11,500	M3
Installation of equipment	:	260	Tons
Piping (Small & medium size)	:	650	Tons
Pumps	:	96	Nos.





## ARAK PETROCHEMICAL COMPLEX

<b>LOCATION</b>	:	Arak, Iran
<b>OWNER</b>	:	Arak Petrochemical Company / Filippo Fochi
<b>SERVICES PROVIDED</b>	:	Construction
<b>TYPE OF CONTRACT</b>	:	Re-Measurable
<b>TYPE OF ASSOCIATION</b>	:	Contractor to Filippo
<b>STATUS</b>	:	Completed, March 1992

### DESCRIPTION AND MAJOR QUANTITIES OF WORKS:

The execution of Offsite civil works including bridges, pipe ways, etc.

Earthworks	:	260,000	M3
Concrete	:	38,000	M3



## METHANOL PLANT

<b>LOCATION</b>	:	Marvdasht near Shiraz, Iran
<b>OWNER</b>	:	National Petrochemical Company
<b>SERVICES PROVIDED</b>	:	Construction and Erection
<b>TYPE OF CONTRACT</b>	:	Re-Measurable
<b>TYPE OF ASSOCIATION</b>	:	Contractor
<b>STATUS</b>	:	Completed, October 1990

### DESCRIPTION OF THE WORKS:

Overall construction and erection of Methanol Plant having daily capacity of 255 MT.





## IRRIGATION CHANNELS

<b>LOCATION</b>	:	Marvdasht, Iran
<b>OWNER</b>	:	Fars Water Organization
<b>SERVICES PROVIDED</b>	:	Construction
<b>TYPE OF CONTRACT</b>	:	Re-Measurable
<b>TYPE OF ASSOCIATION</b>	:	Contractor to Sabir
<b>STATUS</b>	:	Completed, October 1988

### DESCRIPTION OF THE WORKS:

Earth works including stripping and clearing, excavation, removal and back filling operation for over 65 KM of large and medium size irrigation canals related to the Droodzan dam.

## CHLORE-ALKALI PLANT

<b>LOCATION</b>	:	Marvdasht near Shiraz, Iran
<b>OWNER</b>	:	National Petrochemical Company
<b>SERVICES PROVIDED</b>	:	Construction and Erection
<b>TYPE OF CONTRACT</b>	:	Re-Measurable
<b>TYPE OF ASSOCIATION</b>	:	Contractor
<b>STATUS</b>	:	Completed, May 1988

### DESCRIPTION OF THE WORKS:

Construction and erection works for a Chlore-Alkali Plant of 150,000 MTA capacity.



## SHIRAZ PETROCHEMICAL COMPLEX EXPANSION (II) *FERTILIZER PLANT*

<b>LOCATION</b>	:	Marvdasht, Iran
<b>OWNER</b>	:	National Petrochemical Company (NPC)
<b>SERVICES PROVIDED</b>	:	Construction
<b>TYPE OF CONTRACT</b>	:	Re-Measurable
<b>TYPE OF ASSOCIATION</b>	:	Contractor to NPC
<b>STATUS</b>	:	Completed, 1985

### **DESCRIPTION OF THE WORKS:**

Construction including foundations and all pertinent civil works of an Effluent Treatment Plant, Bulk as well as Bagged Product Storing and Loading facilities, 330 TPH steam and 66 MWH power generating unit, Plant Roads and Pavings. The work also included pavements, Marshalling areas, completing of unfinished concrete works of process units and prilling towers.





## **NPC CHEMICAL COMPLEX EXPANSION (I)**

### **FERTILIZER PLANT**



<b>LOCATION</b>	:	Marvdasht near Shiraz, Iran
<b>OWNER</b>	:	National Petrochemical Co. of Iran (NPC)
<b>SERVICES PROVIDED</b>	:	Construction
<b>TYPE OF CONTRACT</b>	:	Re-Measurable
<b>TYPE OF ASSOCIATION</b>	:	Contractor to NPC
<b>STATUS</b>	:	Completed, May, 1980

#### **DESCRIPTION OF THE WORKS:**

Fencing, Site preparation over an area of 600,000 m<sup>2</sup>, road construction, installation of the drainage systems , 13,000 m<sup>2</sup> of industrial buildings, such as warehouse and workshop.

## WASTE DISPOSAL LAGOONS

<b>LOCATION</b>	:	Marvdasht near Shiraz, Iran
<b>OWNER</b>	:	National Petrochemical Company (NPC)
<b>SERVICES PROVIDED</b>	:	Construction
<b>TYPE OF CONTRACT</b>	:	Re-Measurable
<b>TYPE OF ASSOCIATION</b>	:	Contractor to NPC
<b>STATUS</b>	:	Completed, 1985

### DESCRIPTION OF THE WORKS:

Construction and lining of 3 Nos. earth filled ponds with the total capacity of 1,750,000 m<sup>3</sup>.

Excavation	:	1,750,000 M <sup>3</sup>
Fill	:	1,100,000 M <sup>3</sup>

## OLEFIN PLANT

<b>LOCATION</b>	:	Bandar Imam. Iran
<b>OWNER</b>	:	Iran-Japan Petrochemical Company (IJPC)
<b>SERVICES PROVIDED</b>	:	Construction
<b>TYPE OF CONTRACT</b>	:	Re-Measurable
<b>TYPE OF ASSOCIATION</b>	:	Contractor to IJPC in partnership with Kajima Corp, Japan Corporations, Japan
<b>STATUS</b>	:	Completed, January 1979

### DESCRIPTION OF THE WORKS:

Execution of all civil, architectural and structural works for an Olefin Plant of 330,000 MTA ethylene capacity.



## ELECTROLYSIS PLANT

<b>LOCATION</b>	:	Bandar Imam, Iran
<b>OWNER</b>	:	Iran-Japan Petrochemical Company (IJPC)
<b>SERVICES PROVIDED</b>	:	Construction
<b>TYPE OF CONTRACT</b>	:	Re-Measurable
<b>TYPE OF ASSOCIATION</b>	:	Contractor to IJPC in partnership with Kajima and Hazama Corporations, Japan
<b>STATUS</b>	:	Completed, February, 1979

### DESCRIPTION OF THE WORKS:

Execution of all civil, architectural and structural works for an Electrolysis Plant forming part of the production facilities to produce 220,000 MTA chlorine.

## CHLORINE-ALKALI PLANT

<b>LOCATION</b>	:	Bandar Imam, Iran
<b>OWNER</b>	:	Iran-Japan Petrochemical Company (IJPC)
<b>SERVICES PROVIDED</b>	:	Construction
<b>TYPE OF CONTRACT</b>	:	Re-Measurable
<b>TYPE OF ASSOCIATION</b>	:	Contractor to IJPC in partnership with Kajima and Hazama Corporations, Japan
<b>STATUS</b>	:	Completed, February, 1979

### DESCRIPTION OF THE WORKS:

Execution of all civil, architectural and structural works for a Chlorine-Alkali Plant of 220,000 MTA chlorine capacity.

## CENTRAL CONCRETE MIXING PLANT

<b>LOCATION</b>	:	Bandar Imam, Iran
<b>OWNER</b>	:	Iran-Japan Petrochemical Company (IJPC)
<b>SERVICES PROVIDED</b>	:	Construction, Erection, and Operation
<b>TYPE OF CONTRACT</b>	:	Re-Measurable
<b>TYPE OF ASSOCIATION</b>	:	Contractor to IJPC in partnership with Kajima Corporations, Japan
<b>STATUS</b>	:	Completed, March, 1978

### DESCRIPTION OF THE WORKS:

Supply, construction, erection, operation and management of a fully automatic central concrete mixing plant for the entire Complex.

## SOLAR SALT-WORKS

<b>LOCATION</b>	:	Bandar Imam, Iran
<b>OWNER</b>	:	Iran Japan Petrochemical Company (IJPC)
<b>SERVICES PROVIDED</b>	:	Construction
<b>TYPE OF CONTRACT</b>	:	Re-Measurable
<b>TYPE OF ASSOCIATION</b>	:	Contractor to Iran Japan Petrochemical Company (IJPC)
<b>STATUS</b>	:	Completed, August 1977

### DESCRIPTION OF THE WORKS:

Construction of 24,000,000 m<sup>2</sup> of diked evaporation ponds including pumping stations, channels, weirs, dams, sluice gates and other pertinent appurtenances.

Excavation	:	1,700,000 M <sup>3</sup>
Fill	:	1,500,000 M <sup>3</sup>





## IJPC PILE FACTORY

<b>LOCATION</b>	:	Bandar Imam, Iran
<b>OWNER</b>	:	Iran Japan Petrochemical Company (IJPC)
<b>SERVICES PROVIDED</b>	:	Construction
<b>TYPE OF CONTRACT</b>	:	Re-Measurable
<b>TYPE OF ASSOCIATION</b>	:	Contractor to Nippon Concrete Industrial Company Ltd. Japan
<b>STATUS</b>	:	Completed, January 1977

### DESCRIPTION OF THE WORKS:

Execution of civil construction works including pile diving, reinforced concrete foundation erection of steel structure design and construction of industrial and social building such as warehouse, control house workshops, laboratory, offices, dormitories and related facilities.

## LPG BLENDING AND LOADING FACILITIES

<b>LOCATION</b>	:	Bandar Mahshahr
<b>OWNER</b>	:	Oil Service Company of Iran (OSCO)
<b>SERVICES PROVIDED</b>	:	Construction and Erection
<b>TYPE OF CONTRACT</b>	:	Re-Measurable
<b>TYPE OF ASSOCIATION</b>	:	Contractor
<b>STATUS</b>	:	Completed

### DESCRIPTION OF THE WORKS:

Turn-key construction, erection and commissioning of LPG blending and loading unit.

## IRNIP PLASTICIZER PLANT

<b>LOCATION</b>	:	Bandar Imam, Iran
<b>OWNER</b>	:	Iran Nippon Petrochemical Company (IRNIP)
<b>SERVICES PROVIDED</b>	:	Construction
<b>TYPE OF CONTRACT</b>	:	Re-Measurable
<b>TYPE OF ASSOCIATION</b>	:	Contractor to Mitsubishi Heavy Industries/Japan
<b>STATUS</b>	:	Completed: October 1976

### DESCRIPTION OF THE WORKS:

Construction of preliminary site facilities, execution of all civil works and industrial buildings as well as part of the steel structure.





## SITE DEVELOPMENT

---

<b>LOCATION</b>	:	Bandar Mahshahr, Iran
<b>OWNER</b>	:	Iran Nippon Petrochemical Company (IRNIP)
<b>SERVICES PROVIDED</b>	:	Construction
<b>TYPE OF CONTRACT</b>	:	Re-Measurable
<b>TYPE OF ASSOCIATION</b>	:	Contract to owner
<b>STATUS</b>	:	Completed: September 1975

### DESCRIPTION OF THE WORKS:

Site preparation for a housing project including clearing and grubbing, removal and disposal of plant growth and unsuitable materials as well as about 200,000 m<sup>3</sup> of site fill over an area of 16 hectares.

## LAVAN ISLAND OIL DISTILLATION COMPLEX

<b>LOCATION</b>	:	Lavan Island, Persian Gulf
<b>OWNER</b>	:	National Iranian Oil Company (NIOC)
<b>SERVICES PROVIDED</b>	:	Construction and Erection
<b>TYPE OF CONTRACT</b>	:	Re-Measurable
<b>TYPE OF ASSOCIATION</b>	:	Contractor to INGRA, Yugoslavia
<b>STATUS</b>	:	Completed: May, 1976

### **DESCRIPTION OF THE WORKS:**

Implementation including testing of a 20,000 BPSD atmospheric distillation plant comprising, inter alia:

The pertinent civil works:

Including earthmoving, road works, lank foundation, bund walls, reinforced concrete foundations, reinforced concrete paving. Sewer systems, fire-fighting and water supply system including sea water intake and pump station, as well as construction of all industrial buildings such as workshop/warehouse, chemical store, laboratory I office, control room, power plant etc. and all structural steel erection works; as well as

Mechanical works:

Such as pipe fabrication and pipe erection, equipment erection, assembly and alignment of machinery, testing of piping and equipment, insulation as well as erection of 5,000 tons of storage tanks and pertinent land farm piping.



## CARBON BLACK PLANT

<b>LOCATION</b>	:	Near Ahwaz, Iran
<b>OWNER</b>	:	Iran Carbon Company (ICC)
<b>SERVICES PROVIDED</b>	:	Construction and Erection
<b>TYPE OF CONTRACT</b>	:	Re-Measurable
<b>TYPE OF ASSOCIATION</b>	:	Contractor to SIMON CARVES, England
<b>STATUS</b>	:	Completed: February, 1976

### DESCRIPTION OF THE WORKS:

Turn-key implementation of a carbon black plant comprising, inter alia: The execution of all pertinent civil works including grading, roadworks, reinforced concrete foundations and paving, rainwater drainage, sewers, fencing, etc. as well as construction of the industrial buildings such as shops and storage building, warehouse and packing building, office, laboratory and canteen building, bath house, control building, guard house, paint and storage building, utility building as well as feedstock and fire pump houses.

The execution of the mechanical works, such as pipe fabrication and erection, equipment erection, assembly and alignment of machinery, the installation of the electrical and instrumentation systems as well as the performance of the insulation and painting works.





## SODA ASH PLANT, NEAR SHIRAZ

<b>LOCATION</b>	:	Near Shiraz, Iran
<b>OWNER</b>	:	National Petrochemical Company of Iran (NPC)
<b>SERVICES PROVIDED</b>	:	Construction and Erection
<b>TYPE OF CONTRACT</b>	:	Re-Measurable
<b>TYPE OF ASSOCIATION</b>	:	Contractor
<b>STATUS</b>	:	Completed: September, 1973

### DESCRIPTION OF THE WORKS:

Turn-key implementation including testing of a 63,000 MTPY soda ash and bicarbonate plant comprising, inter alia:

The transportation to Iran of 12,000 Tons of foreign supplies, the pertinent civil works, all structural erection, the installation of the electrical and instrumentation systems as well as the entire mechanical works, i.e. Pipe fabrication and pipe erection, equipment erection, assembly and alignment of machinery, testing of piping and equipment, insulation and painting.

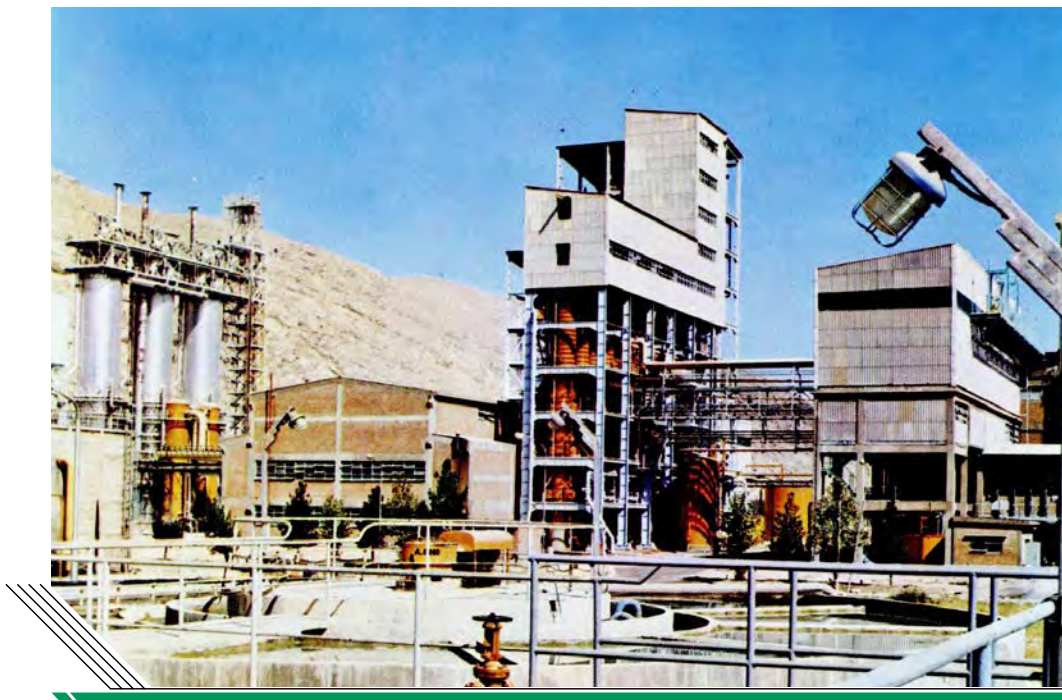

## NIOC FARS REFINERY, SHIRAZ

<b>LOCATION</b>	:	Near Shiraz, Iran
<b>OWNER</b>	:	National Iranian Oil Company (NIOC)
<b>SERVICES PROVIDED</b>	:	Construction and Erection
<b>TYPE OF CONTRACT</b>	:	Re-Measurable
<b>TYPE OF ASSOCIATION</b>	:	Contractor to SNAM PROGETTI, Italy
<b>STATUS</b>	:	Completed: November 1973

### DESCRIPTION OF THE WORKS:

Execution of all pertinent civil works including earth moving, roadworks, tank foundations, bund walls, reinforced concrete paving, rain water drainage, sewers, fencing etc., as well as construction of all industrial buildings such as workshop, warehouse, laboratory, control house, fire-house, electrical stations and cooling tower.

Also including such mechanical works as fabrication, erection and testing of the entire off-site piping as well as assembly and erection of all off-site machinery and equipment including about 5,700 tons of steel structure.



## ALBORZ TOPPING PLANT

<b>LOCATION</b>	:	Ghom, Iran
<b>OWNER</b>	:	National Iranian Oil Company (NIOC)
<b>SERVICES PROVIDED</b>	:	Construction and Erection
<b>TYPE OF CONTRACT</b>	:	Re-Measurable
<b>TYPE OF ASSOCIATION</b>	:	Contractor
<b>STATUS</b>	:	Completed: December, 1963

### DESCRIPTION OF THE WORKS:

Turn-key implementation including testing of a 10,000 bbl. /day atmospheric topping plant comprising, inter alia:

The pertinent civil works; all structural steel fabrication and erection, the installation of the electrical and instrumentation systems as well as the entire mechanical works, i.e., pipe fabrication and pipe erection, equipment erection, assembly and alignment of machinery and testing of piping and equipment.

The distillation unit of this plant had previously been operating at Abadan, Iran. Its re-erection at Ghom involved a considerable amount of equipment repair re-shaping of old as well as fabrication of new components.





## CEMENT FACTORY

<b>LOCATION</b>	:	Near Esfahan, Iran
<b>OWNER</b>	:	Sepahan Cement Company (S.C.C.)
<b>SERVICES PROVIDED</b>	:	Construction and Erection
<b>TYPE OF CONTRACT</b>	:	Re-Measurable
<b>TYPE OF ASSOCIATION</b>	:	Contractor
<b>STATUS</b>	:	Completed: 1974

### DESCRIPTION OF THE WORKS:

Fabrication of 800 tons of steel structures consisting of raw material bunkers and two fuel tanks having a capacity of 5,000 m<sup>3</sup> each.

## SUGAR FACTORY

<b>LOCATION</b>	:	Ghouchan near Birjand, Iran
<b>OWNER</b>	:	Ghouchan Sugar Company (GSC)
<b>SERVICES PROVIDED</b>	:	Construction and Erection
<b>TYPE OF CONTRACT</b>	:	Re-Measurable
<b>TYPE OF ASSOCIATION</b>	:	Contractor to C.J.B., U.K.
<b>STATUS</b>	:	Completed

### DESCRIPTION OF THE WORKS:

Erection of all steel structures and fabrication and erection of part of the piping.

## FERTILIZER PLANT



<b>LOCATION</b>	:	Near Shiraz, Iran
<b>OWNER</b>	:	National Petrochemical Company of Iran (NPC)
<b>SERVICES PROVIDED</b>	:	Erection
<b>TYPE OF CONTRACT</b>	:	Re-Measurable
<b>TYPE OF ASSOCIATION</b>	:	Contractor to C.J.B., U.K.
<b>STATUS</b>	:	Completed, July 1985

### **DESCRIPTION OF THE WORKS:**

Erection of all steel structures and fabrication and erection of part of the piping.

## ORE LOADING PLANT



<b>LOCATION</b>	:	Bandar Abbas, Persian Gulf
<b>OWNER</b>	:	Iranian Ports and Shipping Organization (PSO)
<b>SERVICES PROVIDED</b>	:	Erection
<b>TYPE OF CONTRACT</b>	:	Re-Measurable
<b>TYPE OF ASSOCIATION</b>	:	Contractor to STOKVIS, Holland
<b>STATUS</b>	:	Completed, January 1968

### **DESCRIPTION OF THE WORKS:**

Erection of complete ore loading facilities extending into the sea.



## 66 KV. POWER TRANSMISSION LINE

<b>LOCATION</b>	:	Marvdasht, near Shiraz, Iran
<b>OWNER</b>	:	Fars Regional Electricity Company
<b>SERVICES PROVIDED</b>	:	Construction and Erection
<b>TYPE OF CONTRACT</b>	:	Re-Measurable
<b>TYPE OF ASSOCIATION</b>	:	Contractor
<b>STATUS</b>	:	Completed 1973
	:	

### DESCRIPTION OF THE WORKS:

Supply, fabrication and erection of 50 Nos. galvanized steel towers for a 66 KV 12 KM long power transmission line connecting Polkhan with the Iran Fertilizer Company (IFC) Complex and the Meal Complex at Marvdasht near Shiraz. The works comprised the installation of the cables including all auxiliary works for the above route and for a second line between Polkhan and the Fertilizer Complex.

## 10,000 KVA POWER PLANT

<b>LOCATION</b>	:	Tehran
<b>OWNER</b>	:	Tehran Electricity Board
<b>SERVICES PROVIDED</b>	:	Construction and Erection
<b>TYPE OF CONTRACT</b>	:	Re-Measurable
<b>TYPE OF ASSOCIATION</b>	:	Contractor to WESTINGHOUSE, U.S.A
<b>STATUS</b>	:	Completed 1972

### DESCRIPTION OF THE WORKS:

Erection of the steel structures; fabrication and erection of the piping and erection of part of the mechanical installations including tanks.

## VEGETABLE OIL EXTRACTION UNIT

<b>LOCATION</b>	:	Behshahr, Iran
<b>OWNER</b>	:	Behshahr Industrial Group
<b>SERVICES PROVIDED</b>	:	Construction and Erection
<b>TYPE OF CONTRACT</b>	:	Re-Measurable
<b>TYPE OF ASSOCIATION</b>	:	Contractor
<b>STATUS</b>	:	Completed, August, 1957

### DESCRIPTION OF THE WORKS:

Fabrication and erection of all steel structures, piping and tankage.

## NIOC TEHRAN NORTH WEST OIL Tank Farm

<b>LOCATION</b>	:	Kan, North West Tehran National Iranian Oil Company
<b>OWNER</b>	:	(NIOC)
<b>SERVICES PROVIDED</b>	:	Construction and Erection
<b>TYPE OF CONTRACT</b>	:	Re-Measurable
<b>TYPE OF ASSOCIATION</b>	:	Contractor to NIOC
<b>STATUS</b>	:	Completed, August, 1957

### DESCRIPTION OF THE WORKS:

Erection of 6 Nos. oil tanks of up to 125,000 bbls. and weighing 3,000 tons in total.

## NIOC REY DEPOT

<b>LOCATION</b>	:	Rey, Tehran
<b>OWNER</b>	:	National Iranian Oil Company (NIOC)
<b>SERVICES PROVIDED</b>	:	Construction and Erection
<b>TYPE OF CONTRACT</b>	:	Re-Measurable
<b>TYPE OF ASSOCIATION</b>	:	Contractor to NIOC
<b>STATUS</b>	:	Completed 1974

### DESCRIPTION OF THE WORKS:

Dismantling of 2 Nos. existing tanks of 125,000 bbl. capacity each. Erection of 5 Nos. 250,000 bbl. oil tanks weighing 1,000 tons each and 5,000 tons in total.

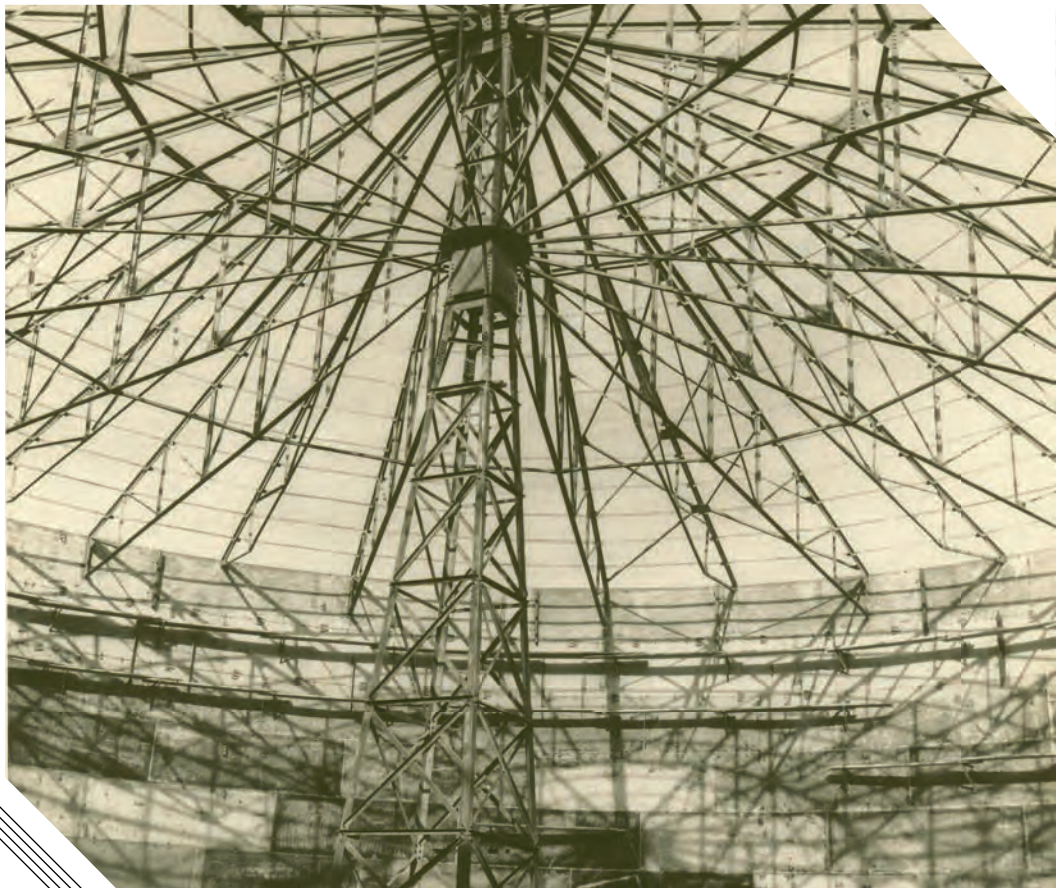

## MICROWAVE RADIO STATIONS

<b>LOCATION</b>	:	Throughout Iran
<b>OWNER</b>	:	National Iranian Oil Company (NIOC)
<b>SERVICES PROVIDED</b>	:	Construction
<b>TYPE OF CONTRACT</b>	:	Re-Measurable
<b>TYPE OF ASSOCIATION</b>	:	Contractor to PHILIPS, Holland
<b>STATUS</b>	:	Completed, January 1970

### DESCRIPTION OF THE WORKS:

Execution of the entire civil works for 94 Nos. microwave radio stations located along the domestic NIOC Pipelines. These works consisted of the construction of access roads to the mountain tops and grading of the site areas involving a considerable amount of rock blasting, construction of the radio station buildings, placing of the reinforced concrete radio tower foundations and the fencing of the station compounds.

## ABADAN PETROCHEMICAL PLANT SEWAGE DISPOSAL

<b>LOCATION</b>	:	Abadan, Iran
<b>OWNER</b>	:	National Petrochemical Company of Iran (NPC)
<b>SERVICES PROVIDED</b>	:	Construction
<b>TYPE OF CONTRACT</b>	:	Re-Measurable
<b>TYPE OF ASSOCIATION</b>	:	Contractor to LUMMUS
<b>STATUS</b>	:	Completed, February, 1968

### DESCRIPTION OF THE WORKS:

Completed construction of the off-site sewage system including 24" diam disposal line.



## ABADAN SEWER SYSTEM

<b>LOCATION</b>	:	Abadan, Iran
<b>OWNER</b>	:	Abadan Municipality
<b>SERVICES PROVIDED</b>	:	Construction
<b>TYPE OF CONTRACT</b>	:	Re-Measurable
<b>TYPE OF ASSOCIATION</b>	:	Contractor
<b>STATUS</b>	:	Completed, July 1969

### DESCRIPTION OF THE WORKS:

Complete construction of the town sewer system of Abadan comprising the laying of about 110 Km. of asbestos cement and cast-iron pipe diam 4" to 20".

## MUNICIPAL WATER TREATMENT PLANT

<b>LOCATION</b>	:	Bakhtaran, Iran
<b>OWNER</b>	:	Ministry of Development and Housing on behalf of the Municipality
<b>SERVICES PROVIDED</b>	:	Construction
<b>TYPE OF CONTRACT</b>	:	Re-Measurable
<b>TYPE OF ASSOCIATION</b>	:	Contractor
<b>STATUS</b>	:	Completed, 1967

### DESCRIPTION OF THE WORKS:

Turn-key construction of the municipal water treatment plant.



## INDUSTRIAL WATER TREATMENT PLANT

<b>LOCATION</b>	:	Soda Ash Plant near Shiraz, Iran
<b>OWNER</b>	:	National Petrochemical Co. of Iran (NPC)
<b>SERVICES PROVIDED</b>	:	Construction and Erection
<b>TYPE OF CONTRACT</b>	:	Re-Measurable
<b>TYPE OF ASSOCIATION</b>	:	Contractor
<b>STATUS</b>	:	Completed, 1973

### DESCRIPTION OF THE WORKS:

Construction of the water treatment facilities pertaining to the 63,000 MTPY soda ash and bicarbonate plant.

## WATER RESERVOIRS AND PUMPING STATIONS

<b>LOCATION</b>	:	Various Townships all over Iran
<b>OWNER</b>	:	Plan Organization on behalf of the Municipalities
<b>SERVICES PROVIDED</b>	:	Construction and Erection
<b>TYPE OF CONTRACT</b>	:	Re-Measurable
<b>TYPE OF ASSOCIATION</b>	:	Contractor
<b>STATUS</b>	:	Completed, 1962 through 1964

### DESCRIPTION OF THE WORKS:

Construction of underground reinforced concrete water reservoir and water towers up to 500 m<sup>3</sup> capacity as well as pumping stations in connection with the implementation of the municipal water supply systems of twelve Iranian townships.



## TOWNSHIP WATER SUPPLY SYSTEMS

<b>LOCATION</b>	:	Yazd Ghouchan Neishabour Naziabad Esfahan (emergency water supply) Semnam Shahrekord Eivanekey Aran Bidgol Daran Fereydoon-Kenar Kermanshah (treatment plant only)
<b>OWNER</b>	:	Plan Organization on behalf of the
<b>SERVICES PROVIDED</b>	:	respective Municipalities Construction and Erection
<b>TYPE OF CONTRACT</b>	:	Re-Measurable
<b>TYPE OF ASSOCIATION</b>	:	Contractor
<b>STATUS</b>	:	Completed, 1962 through 1964

### DESCRIPTION OF THE WORKS:

Turn-key implementation of municipal water supply systems including treatment plants, elevated and underground reservoirs of steel and/or reinforced concrete, erection of steel piping and installation of cement and/or cast iron pipe distribution grids.

## MULTI-STOREY STEEL STRUCTURE BUILDING

<b>LOCATION</b>	:	Tehran (Plasco Building)
<b>OWNER</b>	:	Plasco Building Co.
<b>SERVICES PROVIDED</b>	:	Construction and Erection
<b>TYPE OF CONTRACT</b>	:	Re-Measurable
<b>TYPE OF ASSOCIATION</b>	:	Contractor
<b>STATUS</b>	:	Completed, May 1960

### DESCRIPTION OF THE WORKS:

Fabrication and erection of -16storey steel structure involving 2,000 tons of steel.





## CUSTOMS WAREHOUSES

<b>LOCATION</b>	:	Tehran, Iran
<b>OWNER</b>	:	Customs Authorities
<b>SERVICES PROVIDED</b>	:	Construction
<b>TYPE OF CONTRACT</b>	:	Re-Measurable
<b>TYPE OF ASSOCIATION</b>	:	Contractor to Kandavan Company, Tehran
<b>STATUS</b>	:	Completed 1974

### DESCRIPTION OF THE WORKS:

Fabrication and erection of 4 Nos. large steel structure warehouses.

## TANK FARM PIPING

<b>LOCATION</b>	:	Bahregan, Persian Gulf
<b>OWNER</b>	:	Iran-Italian Oil Company (SIRIP)
<b>SERVICES PROVIDED</b>	:	Construction and Erection
<b>TYPE OF CONTRACT</b>	:	Re-Measurable
<b>TYPE OF ASSOCIATION</b>	:	Contractor to SIRIP
<b>STATUS</b>	:	Completed, July 1965

### DESCRIPTION OF THE WORKS:

Fabrication and erection of C.S. tank farm piping of various diameters in connection with the erection of a 125,000 bbl crude oil Tank at Syrup's Bahregan Oil Center (BOC).

## TOPPING PLANT PIPING



<b>LOCATION</b>	:	Ghum, Iran
<b>OWNER</b>	:	National Iranian Oil Company (NIOC)
<b>SERVICES PROVIDED</b>	:	Erection
<b>TYPE OF CONTRACT</b>	:	Re-Measurable
<b>TYPE OF ASSOCIATION</b>	:	Contractor to NIOC
<b>STATUS</b>	:	Completed, 1963

### DESCRIPTION OF THE WORKS:

Fabrication and erection of all piping in connection with the turn-key implementation of the Alborz Topping Plant.

## OIL DEPOT PIPING



<b>LOCATION</b>	:	NIOC Oil Depot at Rey, Near Tehran
<b>OWNER</b>	:	National Iranian Oil Company (NIOC)
<b>SERVICES PROVIDED</b>	:	Construction and Erection
<b>TYPE OF CONTRACT</b>	:	Re-Measurable
<b>TYPE OF ASSOCIATION</b>	:	Contractor to NIOC
<b>STATUS</b>	:	Completed, September 1970

### DESCRIPTION OF THE WORKS:

Fabrication and erection of the C.S. piping in connection with the erection of 3 Nos. 125,000 bbl. crude oil tanks.





## 10" CRUDE OIL PIPELINE

<b>LOCATION</b>	:	Gash Saran to Schwa, Iran
<b>OWNER</b>	:	National Iranian Oil Co. (NIOC)
<b>SERVICES PROVIDED</b>	:	Construction and Erection
<b>TYPE OF CONTRACT</b>	:	Re-Measurable
<b>TYPE OF ASSOCIATION</b>	:	Contractor to NIOC
<b>STATUS</b>	:	Completed, 1972

### DESCRIPTION OF THE WORKS:

Construction of 120 km. of 10 inch underground crude oil supply line for the NIOC Fan Refinery at Shiraz. The works embrace transportation of the pipe from the Ahwaz pipe mil to the jobsite, the pertaining civil works and all pipe-laying and wrapping activities required for a complete job.

## 36" CRUDE OIL PIPELINE

<b>LOCATION</b>	:	Khark Island, Persian Gulf
<b>OWNER</b>	:	Iran Pan American Oil Co.
<b>SERVICES PROVIDED</b>	:	Construction and Erection
<b>TYPE OF CONTRACT</b>	:	Re-Measurable
<b>TYPE OF ASSOCIATION</b>	:	Contractor to IPAC
<b>STATUS</b>	:	Completed, 1967

### DESCRIPTION OF THE WORKS:

Construction of pipe way and re-inforced concrete pipe supports. Fabrication and erection of 36' diam. Crude oil pipeline between tank farm and shipping manifold including tie-in and installation of the pertinent remote control system at IPAC's Oil Terminal.

## REFINERY PRODUCT PIPELINES



<b>LOCATION</b>	:	Tehran Refinery
<b>OWNER</b>	:	National Iranian Oil Company (NIOC)
<b>SERVICES PROVIDED</b>	:	Construction and Erection
<b>TYPE OF CONTRACT</b>	:	Re-Measurable
<b>TYPE OF ASSOCIATION</b>	:	Subcontractor to FLOUR, U.S.A
<b>STATUS</b>	:	Completed, September 1966

### DESCRIPTION OF THE WORKS:

Fabrication and erection of 10,000 m. of C.S. Product lines of various diameters between the Rev Oil Depot and the Tehran Refinery.

## OIL CATCHMENT DAM



<b>LOCATION</b>	:	Khark Island, Persian Gulf
<b>OWNER</b>	:	Iran Pan American Oil Co. (IPAC)
<b>SERVICES PROVIDED</b>	:	Construction
<b>TYPE OF CONTRACT</b>	:	Re-Measurable
<b>TYPE OF ASSOCIATION</b>	:	Contractor
<b>STATUS</b>	:	Completed, 1967

### DESCRIPTION OF THE WORKS:

Construction of an earth filled oil catchment dam to hold 4,000,000 bbls. of crude.



## TANK PAD FOR 500,000 BBLs. CRUDE OIL TANK

<b>LOCATION</b>	:	Khark Island, Persian Gulf
<b>OWNER</b>	:	Iran Pan American Oil Co. (IPAC)
<b>SERVICES PROVIDED</b>	:	Construction
<b>TYPE OF CONTRACT</b>	:	Re-Measurable
<b>TYPE OF ASSOCIATION</b>	:	Contractor
<b>STATUS</b>	:	Completed, October 1967

### DESCRIPTION OF THE WORKS:

Construction of a reinforced concrete ring foundation and bund walls for a 500,000 bbls. storage tank at IPAC's Oil Terminal

## ERECTION OF I NO. 250,000 BBLs. CRUDE OIL TANK

<b>LOCATION</b>	:	NIOC Depot at Rey, near Tehran
<b>OWNER</b>	:	National Iranian Oil Co. (NIOC)
<b>SERVICES PROVIDED</b>	:	Construction and Erection
<b>TYPE OF CONTRACT</b>	:	Re-Measurable
<b>TYPE OF ASSOCIATION</b>	:	Subcontractor to Toyo-Kanesto (T.K.K.), Japan
<b>STATUS</b>	:	Completed , 1970

### DESCRIPTION OF THE WORKS:

Construction of tank pad and erection of the tank including painting.

## RE-BOTTOMING OF 5 NOS. CRUDE OIL TANKS

<b>LOCATION</b>	:	Bahregan, Persian Gulf
<b>OWNER</b>	:	Iran-Italian Oil Company (SIRIP)
<b>SERVICES PROVIDED</b>	:	Construction (Repair)
<b>TYPE OF CONTRACT</b>	:	Re-Measurable
<b>TYPE OF ASSOCIATION</b>	:	Subcontractor to SIRIP
<b>STATUS</b>	:	Completed, 1971

### DESCRIPTION OF THE WORKS:

Cleaning, re-bottoming and repairing of 5 Nos. up to 125,000 bbls. crude oil tanks at SIRIP's Bahregan Oil Center (BOC)

## ERECTION OF 2 NOS. 125,000 BBLs. CRUDE OIL TANKS

<b>LOCATION</b>	:	NIOC Oil Depot at Rey, near Tehran
<b>OWNER</b>	:	National Iranian Oil Co. (NIOC)
<b>SERVICES PROVIDED</b>	:	Construction and Erection
<b>TYPE OF CONTRACT</b>	:	Re-Measurable
<b>TYPE OF ASSOCIATION</b>	:	Contractor
<b>STATUS</b>	:	Completed, 1972

### DESCRIPTION OF THE WORKS:

Dismantling of the tanks and all pertaining tank farm piping near Abadan; transportation to Rey; transformation from riveted to welded type tanks and re-erection at NIOC's Oil Depot including all related civil works and fabrication and erection of the appurtenant tank farm piping.



## ERECTION OF 1 NOS. 125,000 BBLs. CRUDE OIL TANKS

<b>LOCATION</b>	:	Bahregan, Persian Gulf
<b>OWNER</b>	:	Iran-Italian Oil Company (SIRIP)
<b>SERVICES PROVIDED</b>	:	Construction and Erection
<b>TYPE OF CONTRACT</b>	:	Re-Measurable
<b>TYPE OF ASSOCIATION</b>	:	Contractor
<b>STATUS</b>	:	Completed, 1965

### DESCRIPTION OF THE WORKS:

Dismantling of tank and all pertaining tank farm piping near Abadan; transportation to Bahregan; transformation from riveted to welded type tank and re-erection at SIRIP's Oil Center including all related civil works and fabrication and erection of the appurtenant tank farm piping.

## EXTENSION OF OIL TERMINAL

<b>LOCATION</b>	:	Bahregan, Persian Gulf
<b>OWNER</b>	:	Iran-Italian Oil Company (SIRIP)
<b>SERVICES PROVIDED</b>	:	Construction and Erection
<b>TYPE OF CONTRACT</b>	:	Re-Measurable
<b>TYPE OF ASSOCIATION</b>	:	Subcontractor to SAIPEM, Italy
<b>STATUS</b>	:	Completed, 1971

### DESCRIPTION OF THE WORKS:

Implementation of the entire civil works and of steel structure erection for the extension of SIRIP's Oil Center in connection with the Now-Rooz and the Hendijan Oil Field Developments involving, inter alia: erection of about 400 tons of structural steel



## 68 KM. PUBLIC ROAD

<b>LOCATION</b>	:	Darab to Rostagh, Iran
<b>OWNER</b>	:	Ministry of Road
<b>SERVICES PROVIDED</b>	:	Construction
<b>TYPE OF CONTRACT</b>	:	Re-Measurable
<b>TYPE OF ASSOCIATION</b>	:	Contractor
<b>STATUS</b>	:	Completed, 1966

### DESCRIPTION OF THE WORKS:

Construction of 68 km. feeder road, 8m.wide, including bridges and all other pertinent auxiliary structures.

## 165 KM. OIL PIPELINE SERVICE ROAD

<b>LOCATION</b>	:	Near Khorramabad, Iran
<b>OWNER</b>	:	National Iranian Oil Co. (NIOC)
<b>SERVICES PROVIDED</b>	:	Construction
<b>TYPE OF CONTRACT</b>	:	Re-Measurable
<b>TYPE OF ASSOCIATION</b>	:	Contractor
<b>STATUS</b>	:	Completed, 1970

### DESCRIPTION OF THE WORKS:

Construction of 165 km. all-season road along the NIOC pipeline between Pole-Baba Hossein and Tang-e-Fani pumping stations including bridges and all other pertinent auxiliary structures.



## 132 KM. MICROWAVE STATION ROADS

<b>LOCATION</b>	:	All over Iran
<b>OWNER</b>	:	National Iranian Oil Co. (NIOC)
<b>SERVICES PROVIDED</b>	:	Construction
<b>TYPE OF CONTRACT</b>	:	Re-Measurable
<b>TYPE OF ASSOCIATION</b>	:	Subcontractor to PHILIPS, Holland
<b>STATUS</b>	:	Completed, 1970

### DESCRIPTION OF THE WORKS:

Construction of altogether 132 km. of access roads to microwave stations, mostly located on mountain tops including crossings and all other pertinent auxiliary structures.

## NIOC LABOUR HOUSING PROJECT

<b>LOCATION</b>	:	Gachsaran, Iran
<b>OWNER</b>	:	National Iranian Oil Co. (NIOC)
<b>SERVICES PROVIDED</b>	:	Construction
<b>TYPE OF CONTRACT</b>	:	Re-Measurable
<b>TYPE OF ASSOCIATION</b>	:	Contractor
<b>STATUS</b>	:	Completed, 1976

### DESCRIPTION OF THE WORKS:

Turn-key construction of 50 Nos. labour houses.

## PUBLIC HOUSING PROJECT

---

<b>LOCATION</b>	:	Naziabad, near Tehran
<b>OWNER</b>	:	Ministry of Development and Housing
<b>SERVICES PROVIDED</b>	:	Construction
<b>TYPE OF CONTRACT</b>	:	Re-Measurable
<b>TYPE OF ASSOCIATION</b>	:	Contractor
<b>STATUS</b>	:	Completed, 1963

### DESCRIPTION OF THE WORKS:

Turn-key construction of 250 Nos. public housing units.

## PUBLIC HOUSING PROJECT

---

<b>LOCATION</b>	:	Rahimabad, Iran
<b>OWNER</b>	:	Plan Organization on behalf of Municipality
<b>SERVICES PROVIDED</b>	:	Construction
<b>TYPE OF CONTRACT</b>	:	Re-Measurable
<b>TYPE OF ASSOCIATION</b>	:	Contractor
<b>STATUS</b>	:	Completed, 1963

### DESCRIPTION OF THE WORKS:

Trim-key construction of 80 Nos. housing units and public buildings.

## BANKING INSTITUTE

<b>LOCATION</b>	:	Tehran
<b>OWNER</b>	:	Central Bank of Iran
<b>SERVICES PROVIDED</b>	:	Construction
<b>TYPE OF CONTRACT</b>	:	Re-Measurable
<b>TYPE OF ASSOCIATION</b>	:	Contractor
<b>STATUS</b>	:	Completed, 1967

### DESCRIPTION OF THE WORKS:

Turn-key construction of the bank institute of Higher Education.



## SENIOR OFFICERS QUARTERS



<b>LOCATION</b>	:	Khark Island, Persian Gulf
<b>OWNER</b>	:	Iran Pan American Oil Co. (IPAC)
<b>SERVICES PROVIDED</b>	:	Construction
<b>TYPE OF CONTRACT</b>	:	Re-Measurable
<b>TYPE OF ASSOCIATION</b>	:	Contractor
<b>STATUS</b>	:	Completed, 1966

### **DESCRIPTION OF THE WORKS:**

Turn-key construction of the superintendent's and senior quarters at IPAC's Oil Terminal.



# List of Projects Summarized by Category

---



## Industrial Plant Construction

- Topping Plant, 10,000 BPSD, NIOC, Alborz field  
Industrial plant near Ghom, turn-key including off-site facilities Construction
- Power Plant, 10,000 KVA, TEB, Tehran, structural, mechanical
- Oil Mill, BIG, Behshahr, structural, mechanical
- Sugar Factory, GSC, Ghohestan near Birjand, Structural, mechanical
- Sugar Factory, A-ASC, Assad-abad, structural, mechanical
- Ore Loading Plant, PSO, Bandar Abbas, structural, mechanical
- Fertilizer Factory, NPC, Marvdasht near Shiraz, structural, mechanical
- Soda Ash Plant, 63,000 MITPY, NPC, Marvdasht near Shiraz, turn-key incling Industrial water treatment system
- Fars Refinery, 40,000 BPSD, NIOC, near Shiraz, civil, building, structural, off-site mechanical
- Oil Distillation Complex, 20,000 BPSD, NIOC, Lavan Island, civil, building, structural, mechanical, insulation, painting
- Carbon Black Plant, 16,000 MTPY, ICC, Ahwaz, turn-key including access road
- Plasticizer Plant, IRNIP, Bandar Khomeini, civil, building, structural
- Cement Factory, ACC, near Esfahan, structural, mechanical
- LPG Blending/Loading Facilities, OSCO, Bandar Mahshahr, turn-key.
- Solar Salt-Works, 24,000,000 sq.m., IJPC, Bandar Khomeini, turn-key



## Industrial Plant Construction (cont'd)

- Pile Factory, IJPC, Bandar Khomeini, civil, building, structural
- Olefin Plant, 330,000 MTPY ethylene, IJPC, Bandar Khomeini, civil, building, structural
- Chlorine-Alkali Plant, 220,000 MTPY, IJPC, Bandar Khomeini, civil, building, structural
- Electrolysis Plant, 220,000 MTPY, chlorine, IJPC, Bandar Khomeini, civil, building, structural
- Concrete Mixing Plant, 90 cu.m./h., IJPC, Bandar Khomeini, turn-key including operation.
- Shiraz Petrochemical Complex Expansion, NPC, Marvdasht near Shiraz, site preparation, roads, civil, building, structural, U.G. piping and sewerage.
- Chlorine-Alkali Plant, 150,000 MTA, NPC, Marvdasht, civil, building, structural, roads, U.G. Piping interconnecting piping, tankage.
- Methanol Plant, 255 MT/day, NPC, Marvdasht, civil, building, structural, roads, mechanical, electrical, instruments, insulation, painting
- Rolling Mill, 500,000 MT/yr, Khorasan Steel Complex,
- Neyshabur, mechanical, piping, electrical, automation, refectory, insulation.
- South Pars Phases 2 & 3 - Onshore Facilities  
Civil Works for Pipe Racks, Pipe Sleeper, Tank Foundation, Reception Facilities Foundation.
- South Pars Phases 4 & 5 - Onshore Facilities  
Civil & Building works.
- South Pars phases 9 & 10- Onshore Facilities  
TGTU Tail Gas Treatment Unit, Plant reception facilities and underground network  
Mechanical Erection, Piping, Structural Steel, Electrical, Instruments, Insulation, Painting

## Industrial Plant Construction (cont'd)

- South Pars phase 12 - Onshore Facilities  
EPC3 (Gas Processing - Gas Treatment, Sulfur Recovery and related Facilities)
- South Pars phase 19 - Onshore Facilities  
Civil, Mechanical, Electrical and I&C Works of Utilities (SC4) and execution of Civil, and Mechanical Works of Gas Sweetening Units & Burn Pit Zone (SC2-2)
- South Pars phase 14 - Onshore Facilities  
Civil, Underground piping network and steel structure of Units 140,141,142,143,145 & 160

## Oil and Produce Piping

- Tank Farm Piping at Behregan Oil Center, SAIRIP
- Plant Piping at Alborz Topping Plant near Ghom, NIOC
- Tank Farm Piping at Rey Oil Depot, NIOC
- Off-Site Piping at Fars Refinery near Shiraz, NIOC
- 2" to 12" Produce Piping, ca. 10,000 m., for Tehran Oil Refinery, NIOC
- Plant Piping at Soda Ash Plant, Marvdasht near Shiraz, NPC
- Plant Piping at Lavan Island Oil Distillation Complex, NIOC
- Plant Piping at Carbon Black Plant, Ahwas, ICC
- 10" Crude Oil Pipeline, 120 km., from Gashsaran to Fars
- Refinery near Shiraz, NIOC
- 36" Crude Oil Pipeline at Kharg Oil Terminal, IPAC
- Plant Piping at Fertilizer Plant, Marvdasht near Shiraz, NPC
- Plant Piping at Tehran Power Plant, Tehran, TEB
- Plant Piping at Behshahr Oil Mill, Behshahr, BIG
- Plant Piping at Assad-Abad Sugar Factory, Assad-Abad, A-ASC



- Plant Piping at Chochestan Sugar Factory near Birjand, GSC

## Oil and Produce Piping (cont'd)

- Plant Piping at Methanol Plant, Marvdasht, NPC
- Plant Piping at Waste Water Treatment Plant, Arak, NIOC
- Piping at Bushehr Fuel Supply Jetty, Bushehr, NIOC
- A/G and U/G piping at South Pars phases 9 & 10, Assaluyeh POGC
- A/G and U/G piping at South Pars phase 12, Assaluyeh POGC
- A/G and U/G piping at South Pars phase 19, Assaluyeh POGC

## Oil and Produce Storage Tanks

- 6 Nos. 250,000 BBL Oil Storage Tanks Erected at Rey Oil Depot, NIOC
- 9 Nos. 17,000 BBL (up to) Oil and Produce Storage Tanks Erected at Oil
- 6 Nos. 125,000 BBL (up to) Oil Storage Tanks Erected at Kan Oil Depot, NIOC
- 2 Nos. 125,000 BBL Oil Storage Tanks Erected at Rey Oil Depot, NIOC
- 1 No. 125,000 BBL Oil Storage Tank Erected at Bahregan Oil Center, SIRIP
- 5 Nos. 125,000 BBL (up to) Oil Storage Tanks Rebottomed at Bahregan Oil Center, SIRIP
- 34 Nos. Oil and Produce Tanks Rebottomed and/or Re-roofed at Abadan Refinery, NIOC
- 2 Nos. 31,250 BBL (5,000 cu.m.) Oil Storage Tanks Fabricated and Erected at Sepahan Cement Factory near Esfahan, SCC



- 1 No. Tank Pad for a 500,000 BBL Oil Storage Tank Constructed at Kharg Island Tank Farm, IPAC
- ### Oil and Produce Storage Tanks(cont'd)

- Various Oil and Produce Tanks Erected at Alborz Topping Plant near Ghom, NIOC
- Various Produce Tanks Erected at Soda Ash Plant, Marvdasht near Shiraz, NPC
- Various Oil and Produce Tanks Erected at Carbon Black Plant, Ahwaz, ICC
- Various Oil and Produce Tanks Erected at Tehran Power Plant, TEB
- Various Oil and Produce Tanks Erected at Behshahr Oil Mill, BIG
- Various Produce Tanks Erection at Shiraz Methanol Plant, Shiraz, NPC
- Various Produce Tanks Erection at C/A Plant, Shiraz, NPC
- Butane & Propane double wall storage tank- South Pars Field Phases 4&5

### Microwave Radio Station

- 94 Nos. of Microwave Stations along the domestic oil pipelines access roads all over Iran, NIOC, building, civil , roads

### Power Transmission Lines

- 66 KV. Power Transmission Line, 12 km., near Shiraz



## Municipal Water Supply Systems

Yazd  
Ghoochan  
Neishabour  
Esfahan (emergency water supply scheme)  
Semnan  
Kermanshah (treatment Plant only)  
Shahrekord  
Aivanekay  
Bidgol  
Daran  
Fereydoonkenar  
Naziabad  
Aran

Turn-Key Implementation including:  
Reservoirs, Water  
Treatment Plants,  
Pumping Stations,  
and Distribution  
Networks

## Industrial Water Treatment Plants

- Soda Ash Plant, Marvdasht near Shiraz, NPC
- Waste Water Treatment Plant,  
Arak 7th Refinery, NIOC
- Pars oil refinery complex- Waste water treatment  
plant

## Sewage Disposal Schemes

- Abadan Petrochemical Plant, Abadan, NPC Sewage Disposal schemes
- Abadan Tower ship, turn-key including pump station
- Effluent Treatment Plant, Shiraz Petrochemical Complex Expansion Project, NPC

## Oil Terminals

- Extension of Bahregan Oil Center, SIRIP, civil, Oil Terminals building, structural
- Extension of Kharg Island Oil Terminal, IPAC, civil, building, structural

## Roads

- 435 km. of Different Types of Roads for diverse Roadowners in various part of Iran

## Earth Filled Dam

- Oil Catchments Dam, Earth-filled, IPAC, Kharg Island Earth Filled Dams Oil terminal
- Earth Filled Dikes, Pumping Stations, Concrete Channels & Gates etc. IJPC, Solar Salt Works, Bandar Khomeini
- Earth Filled Waste Disposal Lagoons, NPC Marvdasht



## Port & Jetties

- Bushehr fuel supply jetty, NIOPDC, dredging, civil Ports & Jettysworks, piles, mechanical, electrical.

## Site Developments

- Site Preparation for Bandar Mahshahr Housing Scheme, IRNIP
- Site Preparation for Fertilizer Complex Expansion, NPC, Marvdasht near Shiraz
- Site Preparation for Zagross Petrochemical Complex, Assaluyeh
- Site Preparation for Jam Petrochemical Complex, Assaluyeh
- Site Preparation for South Pars Phases 4 & 5, Tankage Area, Assaluyeh

## Housing and Commercial Construction

- ca. 200,000 sq.m. of Building Construction for housing, commercial, governmental purposes in various parts of Iran :
- Naziabad Housing Scheme, MDH, 250 units
- Rahimabad Housing Scheme, PO, 80 units
- Gachsaran Housing Scheme, NIOC, 50 units
- Behshahr Military Base, IAF, 30 units
- Banking Institute, Tehran, CBI
- Plasco High-Rise Building, Tehran, Plasco Co.
- Custom Warehouses, Tehran
- Senior Officers Quarters, Lavan, IPAC
- Microwave Radio Station Buildings, 83 units

## Housing and Commercial Construction (cont'd)

- Design & Engineering of camp ( South Pars Field-Phase12)
- Design & Engineering of camp ( South Pars Field-Phase13)

## Industrial Building

- Soda Ash plant, Marvdasht near Shiraz, NPC
- Fars Refinery, near Shiraz, NIOC
- Oil Distillation Complex, Lavan, NIOC
- Carbon Black Plant, Ahwaz, ICC
- Alborz Topping Plant, NIOC
- Solar Salt-Works, Bandar Khomeini, IJPC
- Plasticizer Plant, Bandar Khomeini, IRNIP
- Pile Factory, Bandar Khomeini, IJPC
- Fertilizer Complex, Marvdasht near Shiraz, IFC
- Olefin Plant, Bandar Khomeini, IJPC
- Chlorine-Alkali Plant, Bandar Khomeini, IJPC
- Electrolysis Plant, Bandar Khomeini, IJPC
- General Concrete Mixing Plant, Bandar Khomeini, IJPC
- Methanol Plant, Shiraz, NPC
- Arak Refinery, WWT Plant, NIOC
- South Pars phases 4 & 5, Assaluyeh, POGC
- South Pars phase 12, Assaluyeh, POGC